

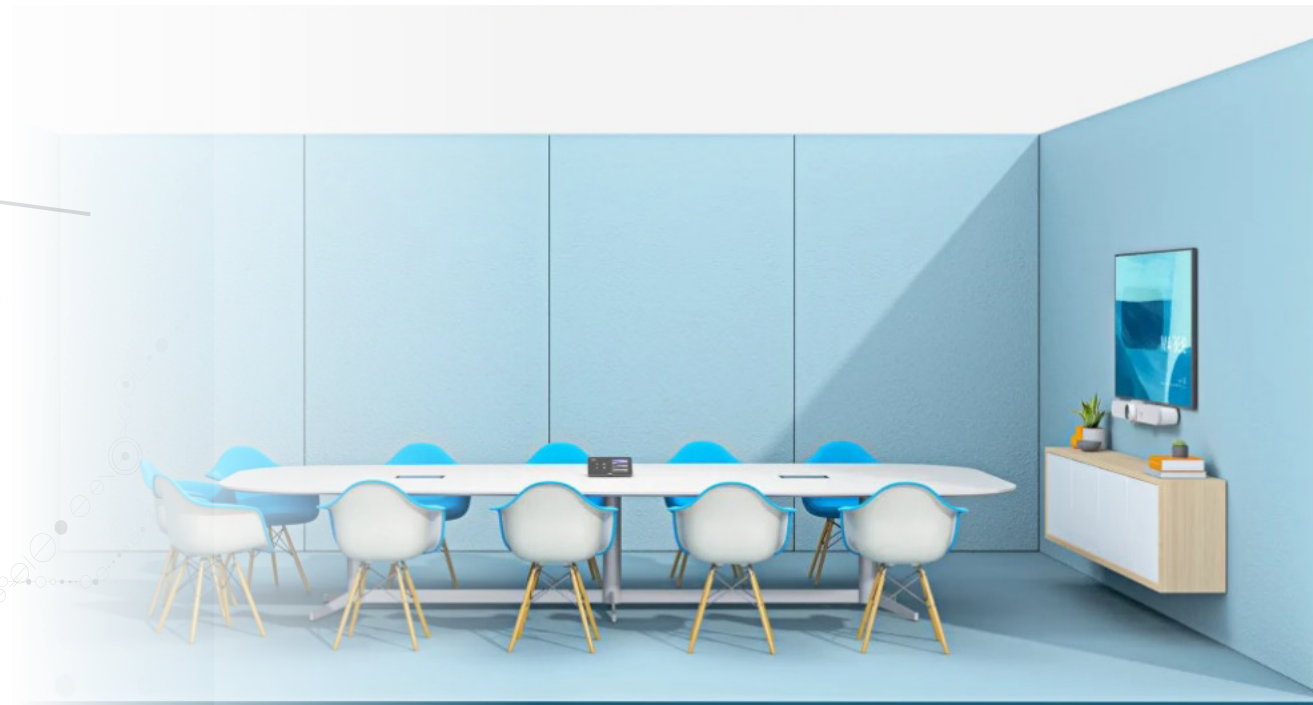

UC GUIDE

logitech®

for  Microsoft Teams



Contents

Introduction	05
Logitech Appliances for Microsoft Teams Rooms (Android).....	06
Logitech Small Room Solution for Microsoft Teams (Android)	07
Logitech Medium Room Solution for Microsoft Teams (Android)	08
Logitech Large Room Solution for Microsoft Teams (Android)	09
Tech Specs	10
Logitech PC Based Solutions for Microsoft Teams Rooms	11
Logitech Small Room Solution for Microsoft Teams (Windows)	12
Logitech Meet Up & Rally Bar Mini feature Comparison	14
Logitech Medium Room Solution for Microsoft Teams (Windows)	15
Logitech Large Room Solution for Microsoft Teams (Windows)	16
Tech Specs	17
Logitech Scribe	18
Logitech Accessories	20
Headsets & Personal Video Cameras	22
Logitech Personal Video Collaboration Kits	32
Management Tools	34



Logitech + Microsoft / Tap into Teams Rooms

Introduction

Transform any space to a Microsoft Teams Rooms meeting place with one-touch join, easy content sharing, and center-of-room control for Teams meetings. You can also leverage “proximity join” from your smartphone or laptop.

Logitech Room Solutions for Microsoft Teams include everything you need for video meetings, available in small, medium, and large configurations. These pre-configured systems include a mini PC, Logitech conferencecam with RightSense™ technologies, PC mount with cable retention, and the Logitech Tap touch controller.

Effortlessly share whiteboards into your Teams meetings by adding Logitech Scribe, an AI-powered whiteboard camera elegantly-designed for the modern office. With Scribe, both remote and in-office workers can have the best seat at the table.

Easily monitor and manage your meeting room devices from the Microsoft Teams Admin Center or Logitech Sync. Plus, get business insights into how your rooms are being used.



REMARKABLY SIMPLE MEETING ROOM SOLUTIONS

Logitech for Microsoft Teams Rooms on Android include an Ultra-HD Logitech conferencecam with motorised pan and tilt, RightSense™ technologies, and the Logitech Tap

touch controller for virtually any room size or shape. Support for Microsoft Teams Rooms on Android means set up is remarkably simple with no need for a PC or Mac. Plus, device management has never been easier through the Microsoft Teams Admin Centre.

Logitech Rally Bar Mini



Small Room
(up to 6 people)

Logitech Rally Bar



Medium Room
(up to 16 people)

Logitech Rally Plus With Roommate



Large Room
(16 - 46 People)

Logitech Appliances for Microsoft Teams Rooms (Android)

Logitech Small Room Solution for Microsoft Teams (Android)



Powered by
android



1

2

Featured Components

LOGITECH RALLY BAR MINI

- > Premier all-in-one video bar with built-in Microsoft Teams Rooms support for small rooms, in graphite or white
- > Motorised pan and tilt lens provides expansive room coverage
- > Ultra-low distortion speakers deliver crystal clear sound
- > AI Viewfinder for enhanced RightSight™ auto-framing and people count
- > Add up to two Rally Mic Pods to extend audio coverage
- > Support for Microsoft Teams Rooms on Android means set up is remarkably simple with no need for a PC or Mac

LOGITECH TAP

- > Touch controller for room solutions with One-touch Join
- > Responsive 10.1" touch screen
- > Commercial-grade cabling and cable management
- > Supports both wired and wireless DirectShare content sharing
- > Optional Table and Riser mounts add convenience and rotate 180° for easy viewing. Or, add a Wall Mount to save space in small and multipurpose rooms

Pre-configured Video Conferencing for Microsoft Teams Rooms

The small room configuration with Logitech Rally Bar Mini delivers superior audio and video in a compact, all-in-one form factor. Clean cabling and flexible mounting options allow you to confidently deploy at scale.

Pre-configured Video Conferencing for Microsoft Teams Rooms

The medium room configuration with Logitech Rally Bar Mini delivers superior audio and video in a compact, all-in-one form factor. Clean cabling and flexible mounting options allow you to confidently deploy at scale.

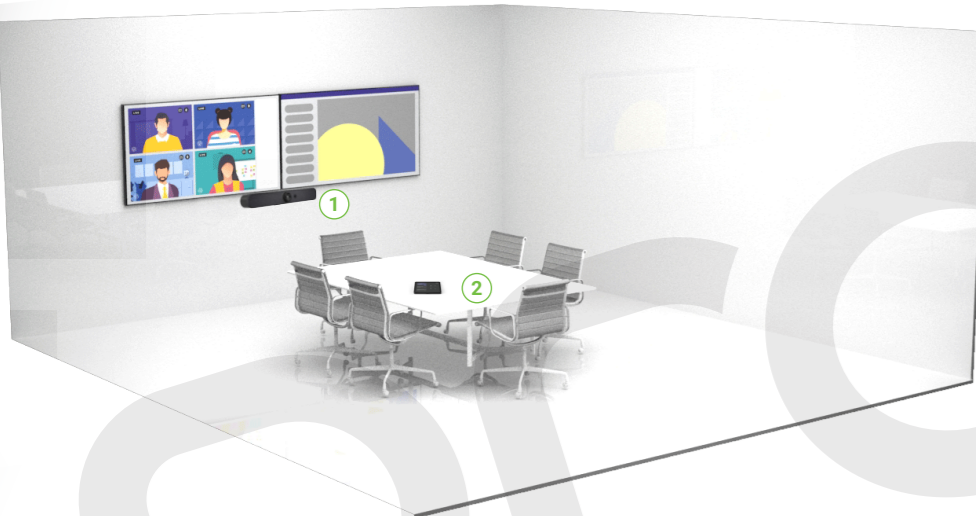

Powered by
android

Logitech Medium Room Solution for Microsoft Teams (Android)

Featured Components

LOGITECH RALLY BAR

- > All-in-one video bar with built-in Microsoft Teams Rooms support for midsize rooms, in graphite or white
- > Support for Microsoft Teams Rooms on Android means set up is remarkably simple with no need for a PC or Mac
- > Lossless image quality up to 5X optical zoom, digitally enhanced to 15X total zoom
- > Large, ultra-low distortion speakers for room-filling sound
- > AI Viewfinder for enhanced RightSight auto-framing and people count
- > Add up to three Rally Mic Pods to extend audio coverage

LOGITECH TAP

- > Touch controller for room solutions with One-touch Join
- > Responsive 10.1" touch screen
- > Commercial-grade cabling and cable management
- > Supports both wired and wireless DirectShare content sharing
- > Optional Table and Riser mounts add convenience and rotate 180° for easy viewing. Or, add a Wall Mount to save space in small and multipurpose rooms

1



2



Logitech Large Room Solution for Microsoft Teams (Android)



Powered by
android



Pre-configured Video Conferencing for Microsoft Teams Rooms

Featuring the expandable Rally Plus conference camera system and Logitech RoomMate computing appliance with built-in Microsoft Teams Rooms software, the large room configuration combines easy management with outstanding coverage across a wide range of room sizes and layouts.

Featured Components

LOGITECH RALLY PLUS: APPLIANCE MODE

- > Modular video conferencing system for large rooms with a computing appliance purpose-built for video collaboration
- > Customisable for large rooms of virtually any size or shape brilliant optics up to 5X optical zoom, digitally enhanced to 15X total zoom
- > Two Rally Speakers and two Rally Mic Pods (extensible up to seven) ensure every voice is clearly heard

LOGITECH ROOMMATE

- > In a sleek, low-profile form factor, Logitech RoomMate delivers all the power you need for HD video conferencing in rooms with one or two displays
- > Built-in support for Microsoft Teams Rooms on Android
- > Purpose built computing appliance for video conferencing rooms

LOGITECH TAP

- > Touch controller for room solutions with One-touch Join
- > Responsive 10.1" touch screen
- > Commercial-grade cabling and cable management
- > Supports both wired and wireless DirectShare content sharing
- > Optional Table and Riser mounts add convenience and rotate 180° for easy viewing. Or, add a Wall Mount to save space in small and multipurpose rooms

1



2



3



Logitech PC Based Solutions for Microsoft Teams Rooms (Windows)

Room Size	Small Room	Medium Room	Large Room
Conference Camera	Logitech Rally Bar Mini	Logitech Rally Bar	Logitech Rally Plus
Microsoft Teams Rooms on Android	Built-in	Built-in	Logitech RoomMate
Logitech Tap Touch Controller	✓	✓	✓
Rally Mounting Kit			✓
Rally Mic Pod Hub			✓
Optional Accessories	Tap Table Mount Tap Riser Mount Tap Wall Mount TV Mount for Video Bars Wall Mount for Video Bars Rally Mic Pod (up to 2 total) Rally Mic Pod Pod Hub Rally Mic Pod Mount Rally Mic Pod Extension Cable Swytch	Tap Table Mount Tap Riser Mount Tap Wall Mount TV Mount for Video Bars Wall Mount for Video Bars Rally Mic Pod (up to 3 total) Rally Mic Pod Pod Hub Rally Mic Pod Mount Rally Mic Pod Extension Cable Swytch	Tap Table Mount Tap Riser Mount Tap Wall Mount Rally Mic Pod (up to 7 total) Rally Mic Pod Pod Hub Rally Mic Pod Mount Rally Mic Pod Extension Cable Swytch



Windows Solutions for every room

Logitech Room Solutions for Microsoft Teams include everything you need to build out meeting rooms of virtually any size or shape—a mini PC, a PC mount, an Ultra-HD Logitech

conferencecam with RightSense™ technologies, and the Logitech Tap touch controller. Plus, device management has never been easier through the Microsoft Teams Admin Centre or Logitech Sync.

Logitech MeetUp



Small Room
(up to 6 people)

Logitech Rally Bar Mini (graphite or white)



Small Room
(up to 6 people)

Logitech Rally Bar



Medium Room
(up to 16 people)

Logitech Rally Plus With Roommate



Large Room
(16 - 46 People)

Super-Wide Field of View for Small Spaces

The Logitech Meetup also thrives in small rooms. It is an all-in-one conference cam that has an ultra-wide lens that is perfect for holding meetings in small rooms. With a compact all-in-one design that minimises cable clutter, MeetUp is USB plug-and-play and simply works right out of the box with any video conferencing software application and cloud service— including the ones you already use.

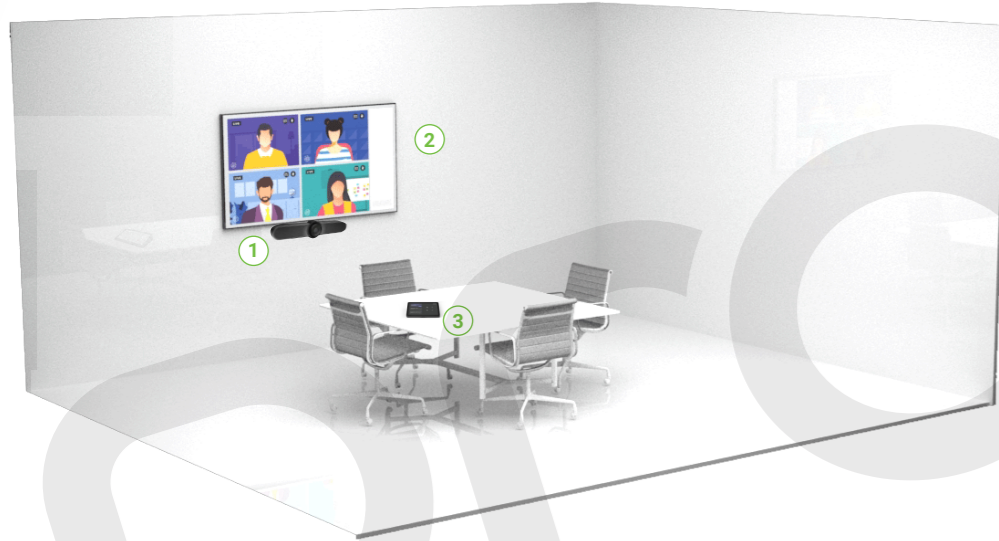

Logitech Small Room Solution for Microsoft Teams (Windows)

1



LOGITECH MEETUP

- > Super-wide 120° field of view
- > Ultra HD 4K image sensor
- > Razor-sharp optics
- > 3-microphones and custom-tuned speaker
- > Motorised pan/tilt
- > 5x HD zoom
- > Plug-and-play USB connectivity

2



MINI PC

- > Small footprint compute of choice from a variety of partners (Lenovo, HP, Intel, Dell)
- > Microsoft-approved
- > PC Mount included to secure PC to walls and beneath tables

3



LOGITECH TAP

- > Touch controller for room solutions with One-touch Join
- > Responsive 10.1" touch screen
- > Commercial-grade cabling and cable management
- > Supports both wired and wireless DirectShare content sharing
- > Optional Table and Riser mounts add convenience and rotate 180° for easy viewing. Or, add a Wall Mount to save space in small and multipurpose rooms

Logitech Small Room Solution for Microsoft Teams (Windows)



PC Based Video Conferencing for Microsoft Teams Rooms

The small room configuration with Logitech Rally Bar Mini delivers superior audio and video in a compact, all-in-one form factor. Clean cabling and flexible mounting options allow you to confidently deploy at scale.

1



LOGITECH RALLY BAR MINI

- > Premier all-in-one video bar for small rooms, in graphite or white
- > Motorised pan and tilt lens provides expansive room coverage
- > Ultra-low distortion speakers deliver crystal clear sound
- > AI Viewfinder for enhanced RightSight™ auto-framing and people count
- > Add up to two Rally Mic Pods to extend audio coverage

2



MINI PC

- > Small footprint compute of choice from a variety of partners (Lenovo, HP, Intel, Dell)
- > Microsoft-approved
- > PC Mount included to secure PC to walls and beneath tables

3



LOGITECH TAP

- > Touch controller for room solutions with One-touch Join
- > Responsive 10.1" touch screen
- > Commercial-grade cabling and cable management
- > Supports both wired and wireless DirectShare content sharing
- > Optional Table and Riser mounts add convenience and rotate 180° for easy viewing. Or, add a Wall Mount to save space in small and multipurpose rooms

Logitech MeetUp & Rally Bar Mini Feature Comparison

There are several key differences between the Meetup and the Rally Bar Mini. They include:

- > The Meetup Certifications (Certified for Skype® for Business, Cisco Jabber™ compatible, Windows, Mac, Microsoft Cortana certified)
- > The Rally Bar Mini Certifications (Certifications: Zoom™ Certified, Certified for Microsoft Teams as a USB device)
- > The Meetup has 3 camera presets, which can be selected and returned to by remote control
- > The Rally Bar Mini has an AI viewfinder camera for automatic scene awareness and auto-framing
- > No computer or laptop is required in appliance mode for the Rally Bar Mini
- > The Rally Bar Mini has 6 integrated beamforming microphones, whereas the Meetup has 3

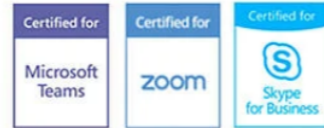
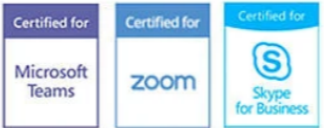
	MeetUp	Rally Bar Mini
Ideal Room Space	Small room	Small room
Total Room Coverage	163° x 110° Horizontal x Vertical	163° x 110° Horizontal x Vertical
Resolution	Ultra HD 4K	Ultra HD 4K
Digital Zoom	5x	4x
Microphone	3-Element Beamforming Array	6-Element Beamforming Array
Audio Capture	4 m	4.5 m
Optional Expansion Mic	✓	✓
RightSense Technologies	✓	✓
Camera	3 Camera Presets + PTZ Camera	AI Viewfinder + PTZ Camera
Operation Mode	USB Mode (BYOD / PC)	USB Mode + Built-In Appliance Mode (No PC Required)
Certifications		

Logitech Medium Room Solution for Microsoft Teams Rooms (Windows)

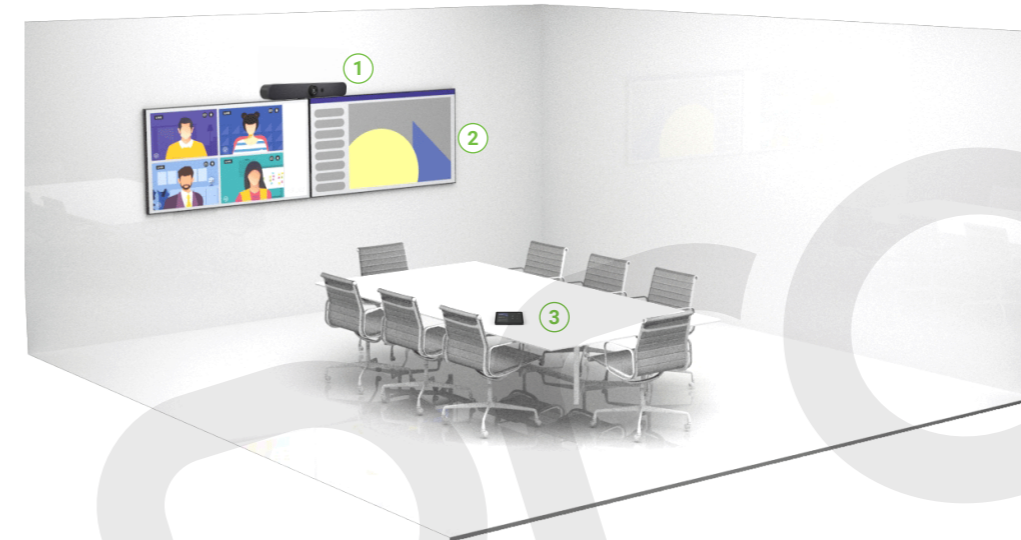

PC Based Video Conferencing Preconfigured for Microsoft Teams

Experience brilliant optics and room-filling audio with the medium room configuration with Logitech Rally Bar, an all-in-one video bar purpose-built for midsize rooms. Mount neatly to the display or wall, or stand on a credenza.

1



LOGITECH RALLY BAR

- > All-in-one video bar for midsize rooms, in graphite or white
- > Lossless image quality up to 5X optical zoom, digitally enhanced to 15X total zoom
- > Large, ultra-low distortion speakers for room-filling sound
- > AI Viewfinder for enhanced RightSight auto-framing and people count
- > Add up to three Rally Mic Pods to extend audio coverage

2



MINI PC

- > Small footprint compute of choice from a variety of partners (Lenovo, HP, Intel, Dell)
- > Microsoft-approved
- > PC Mount included to secure PC to walls and beneath tables

3



LOGITECH TAP

- > Touch controller for room solutions with One-touch Join
- > Responsive 10.1" touch screen
- > Commercial-grade cabling and cable management
- > Supports both wired and wireless DirectShare content sharing
- > Optional Table and Riser mounts add convenience and rotate 180° for easy viewing. Or, add a Wall Mount to save space in small and multipurpose rooms

PC based Video Conferencing Preconfigured for Microsoft Teams

Enjoy maximum flexibility with Logitech Rally Plus for large rooms, a premium conferencecam that pairs an Ultra-HD PTZ camera with modular audio that scales to support a wide range of large room sizes and layouts.



1

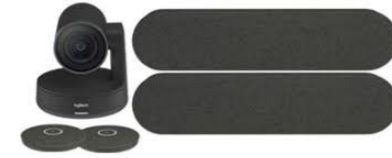

LOGITECH RALLY PLUS

- > Modular video conferencing system for large rooms with a computing appliance purpose-built for video collaboration
- > Customisable for large rooms of virtually any size or shape Brilliant optics up to 5X optical zoom, digitally enhanced to 15X total zoom
- > Two Rally Speakers and two Rally Mic Pods (extensible up to seven) ensure every voice is clearly heard

2



MINI PC

- > Small footprint compute of choice from a variety of partners (Lenovo, HP, Intel, Dell)
- > Microsoft-approved
- > PC Mount included to secure PC to walls and beneath tables

3



LOGITECH TAP

- > Touch controller for room solutions with One-touch Join
- > Responsive 10.1" touch screen
- > Commercial-grade cabling and cable management
- > Supports both wired and wireless DirectShare content sharing
- > Optional Table and Riser mounts add convenience and rotate 180° for easy viewing. Or, add a Wall Mount to save space in small and multipurpose rooms

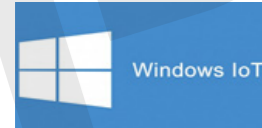

Logitech Large Room Solution for Microsoft Teams Rooms on Windows

Tech Specs

	MeetUp	Rally Bar Mini	Rally Bar	Rally Plus
Room Size	Small	Small	Medium	Large
Conference Camera	Logitech MeetUp	Logitech Rally Bar Mini	Logitech Rally Bar	Logitech Rally Plus
Logitech Tap Touch Controller	Yes	Yes	Yes	Yes
Microsoft-Approved Mini PC	Yes	Yes	Yes	Yes
Windows 10 IOT Enterprise	Yes	Yes	Yes	Yes
Included Mounts	Comes with MeetUp wall mount	None	None	Rally Mounting Kit
Rally Mic Pod Hub	No	No	No	Yes
Optional Accessories	TV Mount for MeetUp TV Mount XL for MeetUp MeetUp Mic Extension Cable Expansion Mic for MeetUp	Tap Table Mount Tap Riser Mount Tap Wall Mount Rally Mic Pod (up to 2 total) Rally Mic Pod Hub TV Mount for Video Bars Wall Mount for Video Bars	Tap Table Mount Tap Riser Mount Tap Wall Mount Tap Rally Mic Pod (up to 3 total) Rally Mic Pod Hub TV Mount for Video Bars Wall Mount for Video Bars Rally Mic Pod Mount	Tap Table Mount Tap Riser Mount Tap Wall Mount Rally Mic Pod (up to 7 total) Rally Mic Pod Hub Rally Mic Pod Mount



Logitech Scribe

Whiteboard Camera for Video Conferencing Rooms

Designed for whiteboard sharing in the modern workplace, Logitech Scribe broadcasts content on dry erase boards into video meetings with outstanding clarity. Now, even remote participants can have the best seat at the table. With a clean wall-mounted design and thoughtful cable management, Scribe installs elegantly and out of the way of meeting collaboration. Together with the whiteboard content camera, Scribe includes a wireless share button, mounting components, power supply, and category cables for deployment at scale.

Features & Benefits

- > Effortlessly share whiteboards into video meetings with Logitech Scribe, an AI-powered whiteboard camera for Microsoft Teams® Rooms, Zoom Rooms, and other leading video conferencing services.
- > Works with all whiteboard surfaces, capturing up to 6' W by 4' H, and any set of dry erase markers.
- > Scribe's wireless share button makes sharing whiteboards into video meetings quick and easy.
- > You can also initiate sharing with your meeting room touch controller, like Logitech Tap.
- > Presenter Removal Scribe's built-in AI delivers a transparency effect, allowing participants to see "through" the presenter for an unobstructed view of the whiteboard.
- > Content Enhancement Scribe automatically enhances the colour and contrast of dry erase markers, making text and sketches easier to read.
- > Sticky Note Detection Scribe uses image segmentation to recognize and show other forms of content like sticky notes.

OPTIONS AND ACCESSORIES



PC MOUNT

Secures the supplied PC to a wall or beneath a table, and includes a cable retention bracket to keep USB, HDMI, power, and network cables tight and secure. Included with all room solutions.



TABLE MOUNT

Secures Tap to a grommet while maintaining a low profile. Swivels 180° for convenient operation from both sides of the table.



RISER MOUNT

Secures Tap to a grommet and raises the viewing angle to 30° for better visibility from across the room. Swivels 180° for convenient operation from both sides of the table.



WALL MOUNT

Conserves table space by mounting Tap flush to the wall with a sturdy plate and cleat design.



TV MOUNT FOR VIDEO BARS

Securely mount your video bar above or below a TV or Monitor.

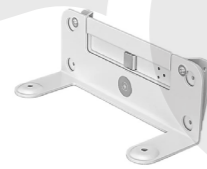

WALL MOUNT FOR VIDEO BARS

Neatly and confidently secure your video bar on the wall for minimal footprint.



RALLY MIC POD

Add Rally Mic Pods to expand audio coverage and provide convenient access to mute controls.



LOGITECH SWITCH

Adds the ability to use the AV equipment in Microsoft Teams Rooms with any video conferencing software, webinar platform, or streaming service. Simply plug in a laptop to start a new meeting.



Headsets and Personal Video Cameras

Logitech Zone Wired Headset



- > Durable wired headset designed for busy open workspaces
- > Open Office-certified using noise-cancelling dual mic technology
- > Works with Windows, macOS, or Chrome OS based computer with available USB-C or USB- port
- > Voice prompts for mute on/off
- > 270 degree rotation (wear the microphone boom on either left or right)
- > Compatible with Zoom

Logitech Zone Wireless Headset



- > Designed for mobile workers, Zone Wireless provides the versatility to wirelessly connect to your computer, tablet, and smartphone simultaneously
- > Immersive sound (great for music and talking)
- > Active noise cancelling mic
- > Wireless range: Up to 30m (open field of sight)
- > Works with Windows, macOS, or Chrome based computer via USB-C, USB-A, Bluetooth and iOS or Android Bluetooth enabled devices
- > 270 degree rotation (wear the microphone boom on either left or right)
- > Compatible with Zoom

Logitech Zone True Wireless Earbuds

Zone True Wireless Bluetooth® Earbuds help users communicate clearly from anywhere with a certified noise-cancelling mic, adaptive hybrid ANC, and immersive sound that is ideal for video meetings.

Features:

- > Noise-cancelling 6-mic array
- > Adaptive hybrid ANC
- > Seamlessly connect and switch between devices
- > Simple on-ear touch controls for volume, music and calls



Logitech Zone Wired Earbuds



Zone Wired Earbuds enable the super-mobile Corridor Warrior to stay in the zone, whether taking video meetings from their desk or on-the-go.

Features:

- > Noise-cancelling, boomless dual mic technology
- > Studio-quality audio
- > Sleek and simple in-line controller
- > Convenient plug-and-play connections

Logitech Logi Dock

Logi Dock is an all-in-one dock for your workspace that simplifies the connections to all your devices.

Features:

- > Single cable dock
- > WFH handsfree audio
- > Automatic audio switch
- > Simple meeting controls
- > Device management



Logitech C920e Business Webcam



HD Video. Incredible Price. C920e is a work-from-anywhere webcam that delivers HD video meetings that look and sound better than most laptop built-ins at a price point that's ideal for mass deployment.

Features:

- > Supports multiple resolutions, including 1080p (Full HD) @30 fps, and 720p (HD) @ 30fps to best support the quality offered by your application and monitor
- > 78° diagonal fixed field of view (dFOV)
- > 1.2x digital zoom (Full HD) available
- > Built-in HD autofocus ensures you're seen clearly throughout video calls
- > RightLight™ 2 auto light correction for clear image in various lighting environments ranging from low light to direct sunlight
- > Dual omni-directional mics, optimised to capture audio clearly from up to one metre away, can be enabled via the Logi Tune app
- > Easily connects via USB-A; cable length of 5 ft (1.5 m)
- > Switch to privacy mode in an instant with the attachable privacy shade
- > Universal clip and 1/4" thread for tripod mounting
- > Certified for Microsoft Teams® and works with all popular calling platforms

Logitech C925e Personal Webcam



The C925e is brilliantly designed for anyone looking to enhance their day-to-day video collaboration. USB plug-and-play connectivity makes it a breeze to set up and operate. It even works with any video conferencing software application, including the ones you already use.

Features:

- > HD 1080p video at up to 30 frames per second
- > UVC H.264 encoding technology
- > 78° field of view
- > Omni-directional dual stereo microphones
- > Convenient privacy shutter
- > Logitech RightLight™ 2 technology and autofocus
- > Easy-to-use
- > Multiple mounting options
- > Certified for Microsoft Teams® and works with all popular calling platforms



Logitech C930e Business Webcam



Experience video calls that are the next best thing to being there in person. Logitech® C930e Webcam delivers clear video and sound in virtually any environment, even low-light conditions.

Features:

- > HD 1080p video quality at 30 frames-per-second brings life-like HD video to conference calls, enabling expressions, non-verbal cues and movements to be seen clearly
- > Widest-ever business webcam field-of-view enjoy an extended view – 90 degrees – perfect for presenting using a whiteboard or doing demos.
- > Logitech RightLight™ 2 technology and autofocus Webcam intelligently adjusts to improve visual quality in low light at multiple distances
- > 4X digital zoom in Full HD
- > Pan, tilt and zoom within the 90-degree field-of-view scene for focused viewing during desktop video conferences.
- > Premium glass lens enjoy razor-sharp images even when showing documents up close, a whiteboard drawing or a product demo
- > Convenient privacy shutter easy lens enclosure for added privacy and security.
- > Plug-and-play USB connectivity
- > Multiple mounting options
- > Certified for Microsoft Teams®. Certifications and compatibility with other popular applications

BRIO Ultra HD pro Business Webcam



Logitech® delivers their best ever webcam with 4K UHD and 5X zoom for truly amazing video quality. Brio's 4K image sensor is a next generation powerhouse that enables 5X digital zoom, high frame rates and multiple resolutions to optimally support any compute/network environment.

Features:

- > 4K Ultra HD
- > 2160p/30fps
- > Full HD 1080p/30 or 60fps
- > HD 720p/30, 60, or 90fps
- > Up to 5 x zoom
- > Plug-and-play USB connectivity
- > Logitech RightLight™ 3 technology and autofocus
- > Attachable privacy shutter
- > 65°, 78°, and 90° diagonal field of view
- > Multiple mounting options
- > Works with all popular calling platforms
- > Business-grade certifications mean you can launch your next presentation or video meeting with complete confidence
- > Certified for Microsoft Teams®. Certifications and compatibility with other popular applications





Logitech Personal Video Collaboration Kits

Wired Personal Video Collaboration kit



- > Includes C925e webcam + ZONE WIRED Headset
- > Full HD video calling (up to 1080p)
- > 78° diagonal field of view
- > Rightlight™ 2 Technology for clarity in various lighting environments, even low light
- > Autofocus
- > Integrated privacy shade
- > 2 omni directional mics
- > Hi-speed USB 2.0 certified (USB 3.0 ready)
- > Tripod-ready universal clip fits laptops, LCD, or CRT monitors

Wireless Personal Video Collaboration Kit



- > Includes C925e webcam + ZONE WIRELESS Bluetooth headset
- > Razor-sharp video at an amazingly affordable price
- > Resolution/FPS: Full HD 1080p/30fps, HD 720p/30fps
- > Sensor resolution: 1920 x 1080
- > Diagonal field of view of 78°
- > Autofocus
- > Digital zoom (Full HD): 1.2x
- > Auto Light Correction: RightLight™ 2
- > USB plug-and-play, Multiple mounting options, Integrated privacy shade

Brio Personal Video Collaboration Kit



- > Includes Logitech's most advanced BRIO webcam + ZONE WIRELESS Bluetooth headset
- > Resolution/FPS: 4k Ultra HD 2160p/30fps, Full HD 1080p/30 or 60 fps, HD 720p/30,60 or 90 fps
- > Sensor resolution: 4096 x 2160
- > Diagonal field of view of 65°, 78°, and 90°
- > Autofocus
- > Digital zoom (Full HD): 5x
- > Auto Light Correction: RightLight™ 3 with HDR
- > Multiple mounting options, External privacy shutter, Infrared for supporting facial login, Background replacement labs project (powered by Personify3), Works with Cortana®

Management Tools

Easily monitor and manage your meeting room devices from Microsoft Teams or Logitech Sync Dashboard. Plus, get business insights into how your rooms are being used.

*Appliance based Solutions are monitored and managed from the Microsoft Teams Admin Centre, PC based solutions can be monitored and managed from either the Microsoft Teams Admin Centre or Logitech Sync

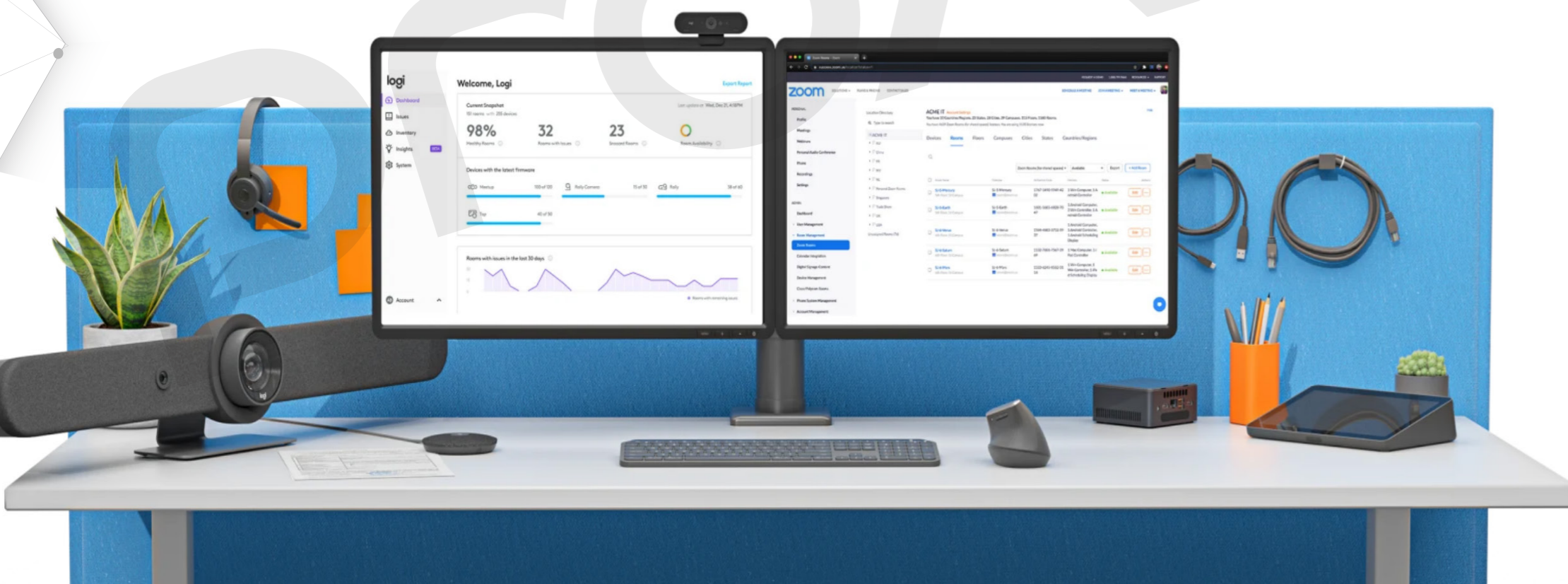

Introducing Logitech Sync

Remote management that scales to thousands of Logitech meeting room devices



MODERN DEVICE MANAGEMENT

Logitech Sync makes it easy to support large-scale video deployments while minimising site visits and trouble tickets—all from a simple browser-based interface.

A fresh approach to remote monitoring and device management simplifies tasks like firmware updates and feature enablement, while an API and forward-looking architecture establish a robust foundation for new insights and integrations.

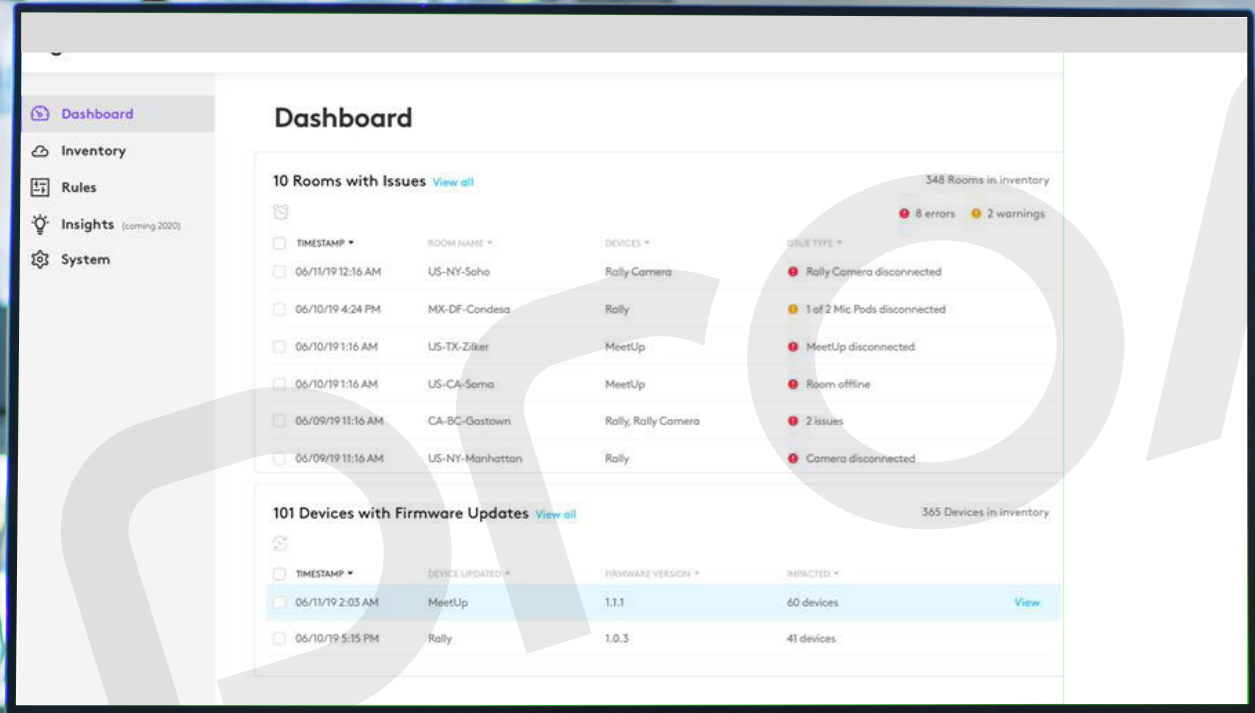

ROOM STATUS IN REAL TIME

Don't wait for a panicked phone call or trouble ticket to surface problems like an offline room or disconnected device.

Sync automatically highlights issues that need your attention in real time and offers in-depth diagnostic info so you can resolve problems before they impact a meeting.

Management

LET SYNC MAKE THE SITE VISITS

Thanks to a modern design that supports both on-demand and scheduled updates, Sync helps you deploy product upgrades and bug fixes to all of your rooms.

Simply select your devices, choose an action, and let Sync make it happen.

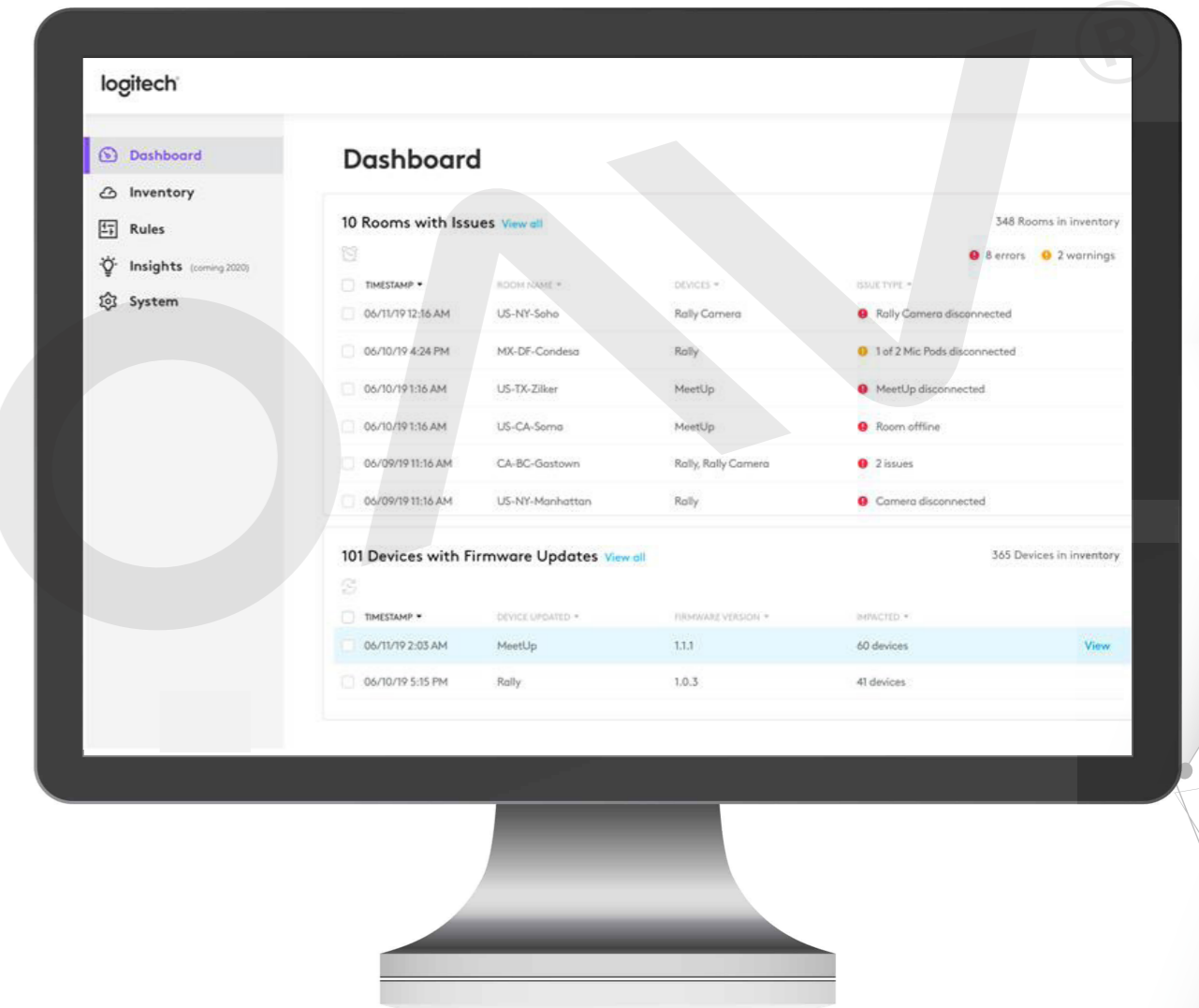

MAKE EVERY MEETING COUNT

Get insights that lead to more efficient and productive meetings.

Informed by rich data about how people use rooms and devices, Sync will help you make the most of your collaboration spaces and technologies

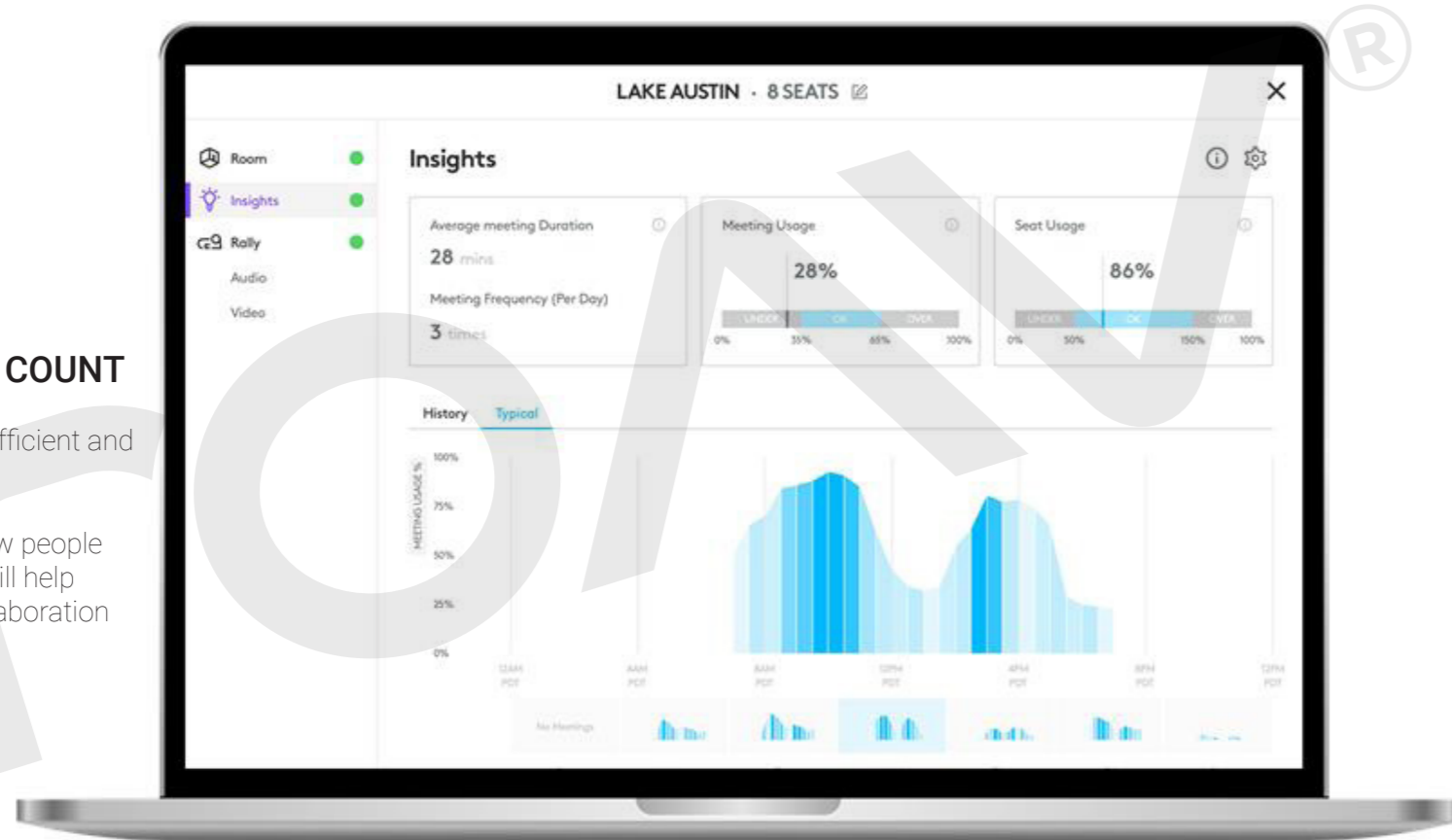

WHY SYNC

Sync offers easy and secure scalability, no matter how many rooms and devices you manage.



MODERN

Sync's intuitive and responsive interface is powered by a cloud-based architecture to accelerate deployment and simplify management



SECURE

Because Sync employs end-to-end encryption and neither collects nor transmits audio, video, or shared content, meeting data remains private and secure



SCALABLE

A capacity of more than 10,000 devices and a platform built for multitenancy make Sync an ideal solution for service providers and enterprise deployments



FREEMIUM

No licenses, no invoices, no maintenance fees. While Logitech will add new capability and value to Sync, core device monitoring and management is free



www.proav.com
uc@proav.com

proAV®